



We are the only supplier of Commando & Dominator parts using the original factory drawings. Our products are mostly made in England and to original specification. We also offer Norton Rotary spares, factory service manuals and literature for **NORTON** and **TRIUMPH** motorcycles.

INSIST ON ANDOVER NORTON PARTS PACKAGED WITH OUR A.N. LOGO

THESE CAST AND FORGED PRODUCTS ARE AVAILABLE FROM STOCK:-

Part	Description	Machine
06.1916	Bottom yoke (750 only)	Commando 750
06.6228	Bottom yoke (850 Mk3)	Commando Mk3
06.4078	Bottom yoke (850 type)	Commando 750/850
06.0344	Bottom yoke (early 750)	Commando 750
06.6649	Top yoke (850 Mk3)	Commando Mk3
06.1131	Top yoke (early 750)	Commando 750
06.4080	Top yoke c/w stem (850 type)	Commando 750/850



06.1131



06.4080



06.4078



06.0344



06.1885

06.1885	Brake disc	Commandos with disc brake
06.5777	Brake pedal	Commando Mk3
06.1054	Brake pedal	Commando 1970-74
06.0479	Brake pedal (Matt Chrome)	Commando 1968-69
06.0374	Chaincase Inner c/w plates	All pre-Mk3 Commandos
06.2585	Chaincase Outer	All pre-Mk3 Commandos



06.5777



06.2585



06.0374



06.1054

06.4045RR	Crankcase Assembly	Commando 750/850 (Race)
06.4045	Crankcase Assembly	Commando 750/850 (Road)
06.5666	Crankcase Assembly	Commando 850 Mk3

Please refer to our Website for Pricing: www.andover-norton.co.uk

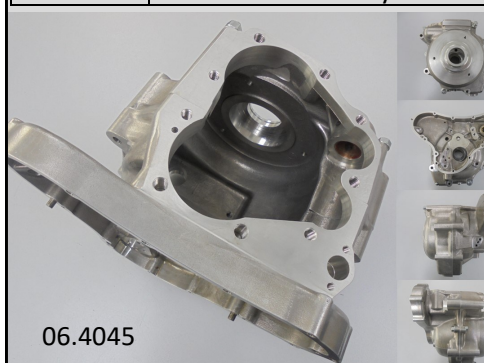

06.4045



06.4045



06.4045



We are the only supplier of Commando & Dominator parts using the original factory drawings. Our products are mostly made in England and to original specification. We also offer Norton Rotary spares, factory service manuals and literature for **NORTON** and **TRIUMPH** motorcycles.

INSIST ON ANDOVER NORTON PARTS PACKAGED WITH OUR A.N. LOGO

THESE CAST AND FORGED PRODUCTS ARE AVAILABLE FROM STOCK:-

Part	Description	Machine
06.1705	Cylinder Barrel	Commando 750
06.5074	Cylinder Barrel	Commando 850

BUY SPARES FROM OUR SALES COUNTER IN
ANDOVER, HAMPSHIRE



06.6263	Footrest Assembly RH	Commando Mk3
06.3118	Footrest assy. LH c/w peg	Commando 1970-74
06.0474	Footrest assy. LH c/w peg (Matt Chrome)	Commando 1968-69
06.3117	Footrest assy. RH c/w peg	Commando 1970-74
06.0473	Footrest assy. RH c/w peg (Matt Chrome)	Commando 1968-69

Please refer to our Website
for Pricing:

www.andover-norton.co.uk



06.3316	Fork Slider LH (Caliper side)	Commandos with disc brake
06.3318	Fork Slider LH (Pinch bolt side)	All Commandos
06.0352	Fork Slider RH (Drum brake)	Commando
03.0030	Fork Slider RH (round section)	Dominator & Altas
03.0031	Fork Slider LH (round section)	Dominator & Altas
06.3547/L	Fork Slider LH	Production Racer
06.3547/R	Fork Slider RH	Production Racer

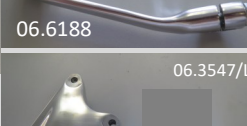
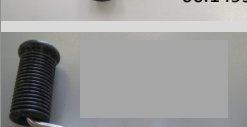
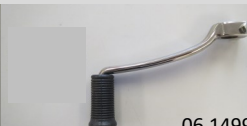
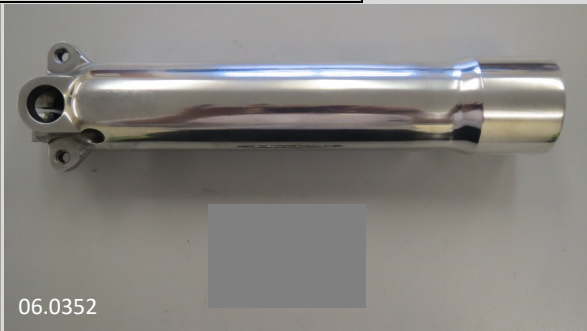

06.1499	Gear change lever assy.	Commando 1970-74
06.6188	Gear change lever assy.	Commando Mk3
06.0929	Gear change lever assy. (Matt Chrome)	Commando 1968-69

Order on-line: www.andover-norton.co.uk tel: 01264 359 565 email: office@andover-norton.co.uk



We are the only supplier of Commando & Dominator parts using the original factory drawings. Our products are mostly made in England and to original specification. We also offer Norton Rotary spares, factory service manuals and literature for **NORTON** and **TRIUMPH** motorcycles.

INSIST ON ANDOVER NORTON PARTS PACKAGED WITH OUR A.N. LOGO

THESE CAST AND FORGED PRODUCTS ARE AVAILABLE FROM STOCK:-

Part	Description	Machine
06.5163	Gearbox inner cover assy	Commando (pre-Mk3) & Dominator
06.5210	Gearbox inner cover assy	Commando Mk3
06.0740	Gearbox outer cover assy	Commando (pre-Mk3)
06.5211	Gearbox outer cover assy	Commando Mk3
06.4126	Gearbox shell	Commando (pre-Mk3) & Dominator
06.5207	Gearbox shell	Commando Mk3

**Call 01264 359 565
for technical advice
on these products.**



06.2819	Inlet manifold 30/28mm	Commando 750
06.5196	Inlet manifold 32/30mm	Commando 750
06.2711	Inlet manifold 32/32mm	Commando 750/850

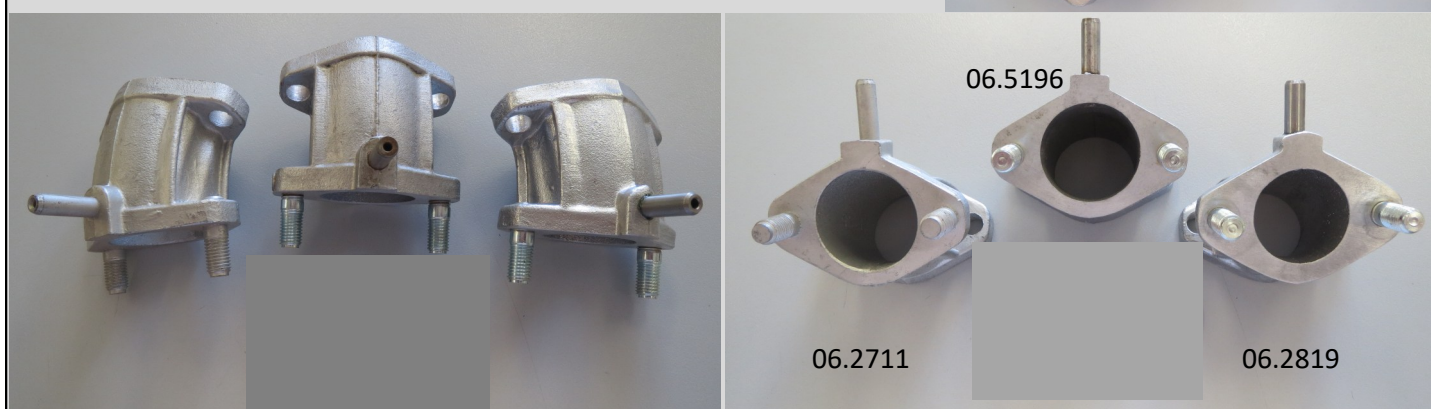

06.4144	Instrument case (long, painted)	Commando 1973 on
06.0510	Instrument case (short, polished)	Commando 1968-72

**BUY SPARES FROM OUR SALES COUNTER IN ANDOVER,
HAMPSHIRE**



06.3139	Oil filter housing	All Commandos
---------	--------------------	---------------



We are the only supplier of Commando & Dominator parts using the original factory drawings. Our products are mostly made in England and to original specification. We also offer Norton Rotary spares, factory service manuals and literature for **NORTON** and **TRIUMPH** motorcycles.

INSIST ON ANDOVER NORTON PARTS PACKAGED WITH OUR A.N. LOGO

THESE CAST AND FORGED PRODUCTS ARE AVAILABLE FROM STOCK:-

Part	Description	Machine
04.0434	Kickstart lever assy.	Dominator
06.1464	Kickstart lever assy. (750)	Commando 1970-73
12.1018	Kickstart lever assy. (850)	Commando 1973 on
06.0598	Kickstart lever assy. (Matt Chrome)	Commando 1968-69
06.7694	Rocker Cover exhaust	Commando & Dominator
06.7695	Rocker Cover inlet	Commando & Dominator
06.1087	Contact breaker cover	All Commandos 1970 on
06.7254	Tacho housing c/w oil seal	All Commandos 1970 on

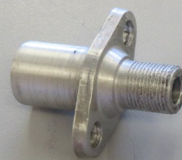

06.7254



06.7694



06.1087



06.7695

06.6161	Timing Cover Assembly Mk3 type	All Commandos
---------	--------------------------------	---------------



06.6161



12.1018



06.1464



06.3281

06.3281	TLS Front brake assy.	Early Commando & Dominator
---------	-----------------------	----------------------------

Every product in this brochure is made, polished and plated in England. Crankcase and gearbox shell castings are made from new dies and are stronger than the originals. Technical details are available upon request.



06.3281



06.3281