



We are the only supplier of Commando & Dominator parts using the original factory drawings. Our products are mostly made in England and to original specification. We also offer Norton Rotary spares, factory service manuals and literature for **NORTON** and **TRIUMPH** motorcycles.

INSIST ON ANDOVER NORTON PARTS PACKAGED WITH OUR A.N. LOGO

NORTON COMMANDO PRIMARY SIDE including ELECTRIC START (850Mk3)

850Mk3 Inner & Outer Chaincase, Hydraulic Tensioner

1 Currently not available 06.6023	Exploded view diagram of the 850Mk3 Inner & Outer Chaincase, Hydraulic Tensioner.	8 06.5185
2 06.7952		9 06.6189
3 06.0355		10 06.5181
4 06.4727		11 06.4694
5 06.5956		12 06.0787
6 06.4689	13 14.0101	14 04.1123
7 06.4691	15 06.0388	15 06.0388
16 06.2581	16 06.2581	16 06.2581
17 06.0659	17 06.0659	17 06.0659
18 06.2580	18 06.2580	18 06.2580
19 06.2582	19 06.2582	19 06.2582
20 06.2583	20 06.2583	20 06.2583



We are the only supplier of Commando & Dominator parts using the original factory drawings. Our products are mostly made in England and to original specification. We also offer Norton Rotary spares, factory service manuals and literature for **NORTON** and **TRIUMPH** motorcycles.

INSIST ON ANDOVER NORTON PARTS PACKAGED WITH OUR A.N. LOGO

NORTON COMMANDO PRIMARY SIDE including ELECTRIC START (850Mk3)

850Mk3 Inner & Outer Chaincase, Hydraulic Tensioner

21 06.5534

22 06.5533

23 06.6257

24 60.2322

25 14.0403

26 06.0397

27 06.4718

28 06.5341

29 06.6001

30 60.2418

31 14.0302

32 06.4717

33 06.3189

34 60.2417



We are the only supplier of Commando & Dominator parts using the original factory drawings. Our products are mostly made in England and to original specification. We also offer Norton Rotary spares, factory service manuals and literature for **NORTON** and **TRIUMPH** motorcycles.

INSIST ON ANDOVER NORTON PARTS PACKAGED WITH OUR A.N. LOGO

NORTON COMMANDO PRIMARY SIDE including ELECTRIC START (850Mk3)

Gear Linkage, Chain, Alternator & Engine Sprocket

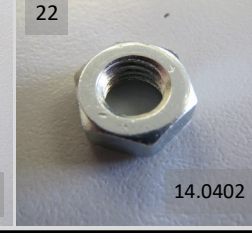
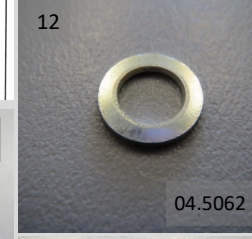
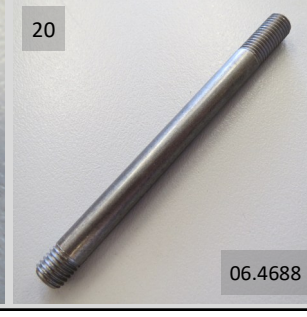
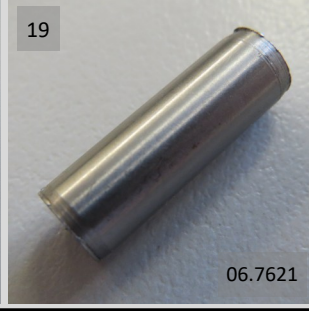
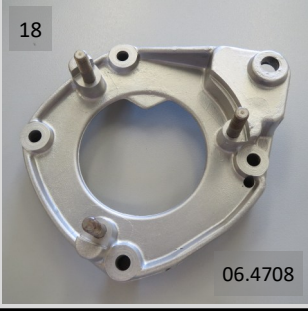
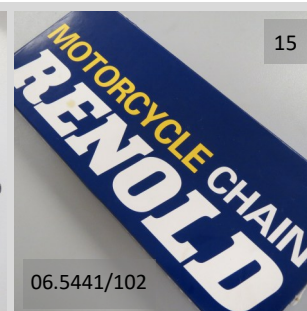
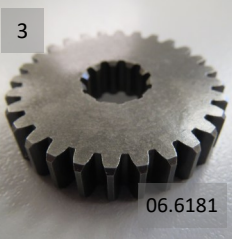
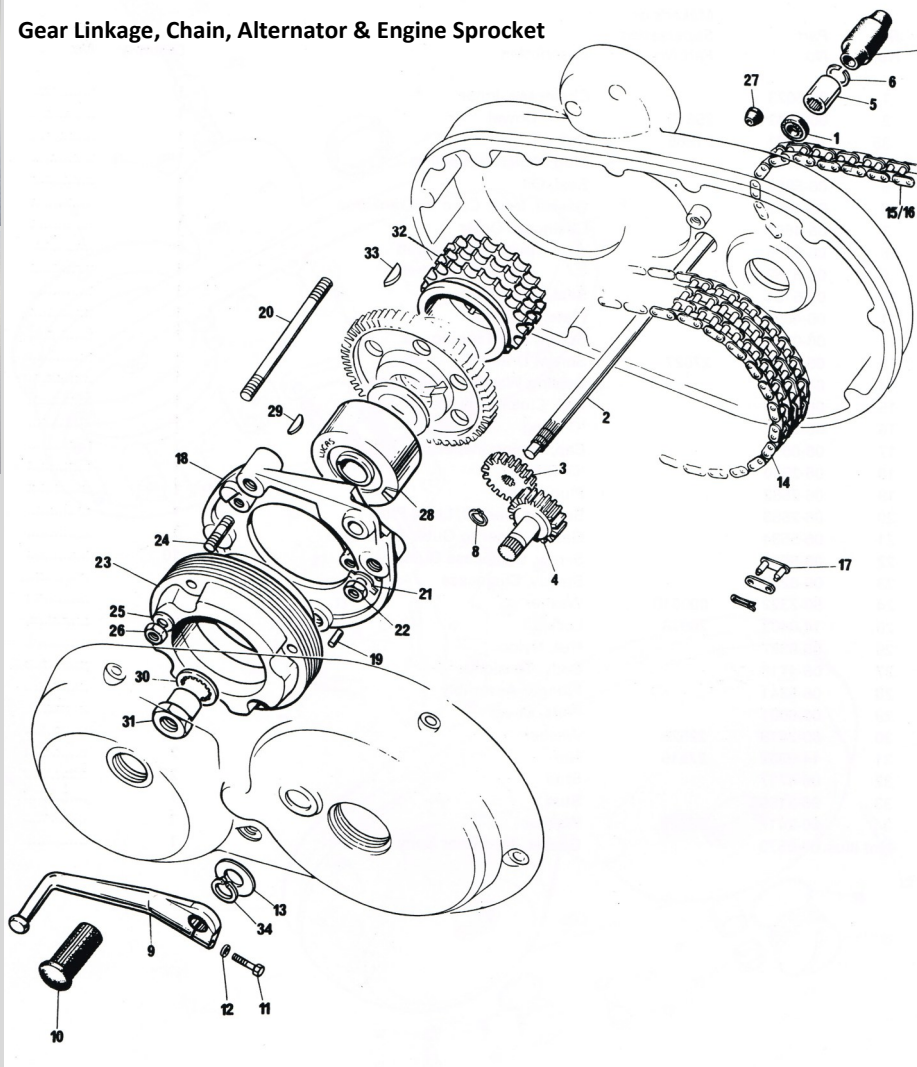



We are the only supplier of Commando & Dominator parts using the original factory drawings. Our products are mostly made in England and to original specification. We also offer Norton Rotary spares, factory service manuals and literature for **NORTON** and **TRIUMPH** motorcycles.

INSIST ON ANDOVER NORTON PARTS PACKAGED WITH OUR A.N. LOGO

NORTON COMMANDO PRIMARY SIDE including ELECTRIC START (850Mk3)

Gear Linkage, Chain, Alternator & Engine Sprocket

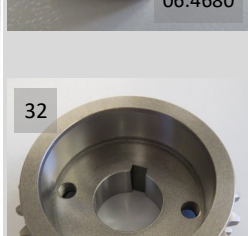
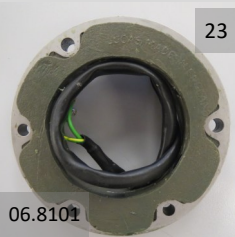
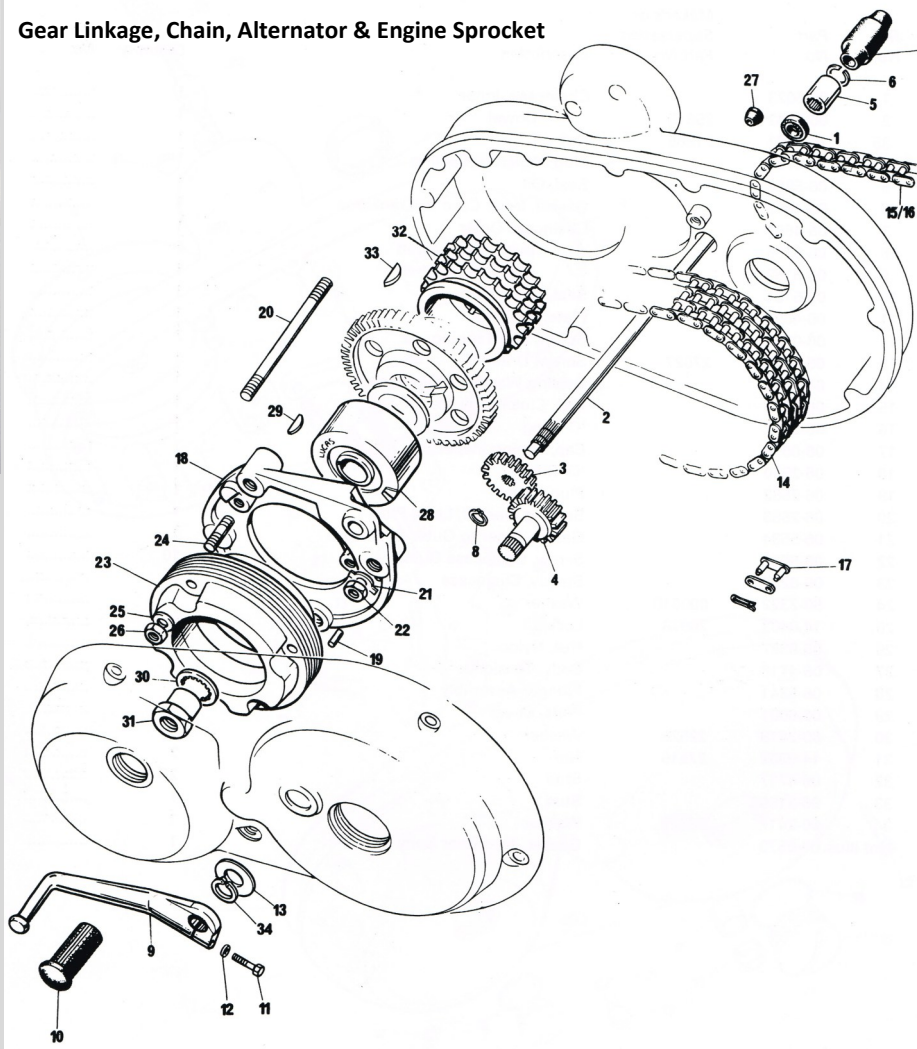



We are the only supplier of Commando & Dominator parts using the original factory drawings. Our products are mostly made in England and to original specification. We also offer Norton Rotary spares, factory service manuals and literature for **NORTON** and **TRIUMPH** motorcycles.

INSIST ON ANDOVER NORTON PARTS PACKAGED WITH OUR A.N. LOGO

NORTON COMMANDO PRIMARY SIDE including ELECTRIC START (850Mk3)

Electric Start

1 06.4704

2 06.4729

3 06.5532

4 06.4703

5 06.4702

6 06.4705

7 06.4743

8 06.4741

9 06.4745

10 06.4740

11 06.4744

12 06.4707

13 06.5652

14 06.4706

15 06.8072

16 06.4754

17 06.5652

18 06.4733

19 06.4731

20 06.4711

21 06.4702

22 06.4705

23 06.4733

24 06.4706

25 06.4706

26 06.4706

27 06.4706

28 06.4706

29 06.4706

30 06.4706

31 06.4706

32 06.4706

33 06.4706

34 06.4706

35 06.4706

36 06.4706

37 06.4706

38 06.4706

39 06.4706

40 06.4706

41 06.4706



We are the only supplier of Commando & Dominator parts using the original factory drawings. Our products are mostly made in England and to original specification. We also offer Norton Rotary spares, factory service manuals and literature for **NORTON** and **TRIUMPH** motorcycles.

INSIST ON ANDOVER NORTON PARTS PACKAGED WITH OUR A.N. LOGO

NORTON COMMANDO PRIMARY SIDE including ELECTRIC START (850Mk3)



24 to 31
Currently not available

