

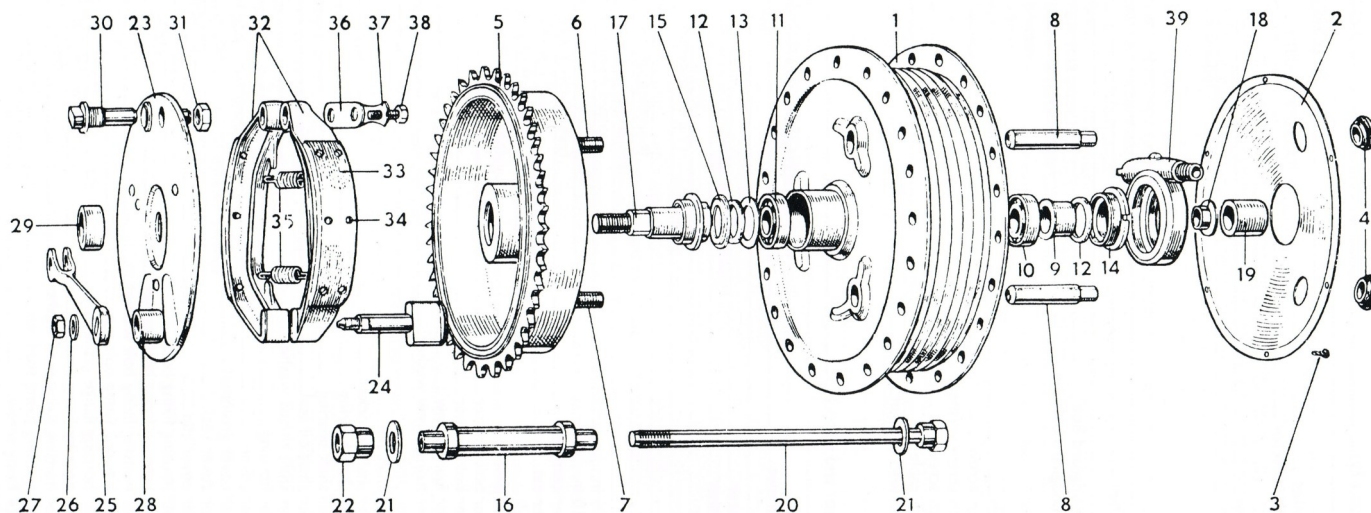

We are the only supplier of Commando & Dominator parts using the original factory drawings. Our products are mostly made in England and to original specification. We also offer Norton Rotary spares, factory service manuals and literature for **NORTON** and **TRIUMPH** motorcycles.

INSIST ON ANDOVER NORTON PARTS PACKAGED WITH OUR A.N. LOGO

NORTON COMMANDO REAR WHEEL (Non Cush drive type 1968 to 1972)

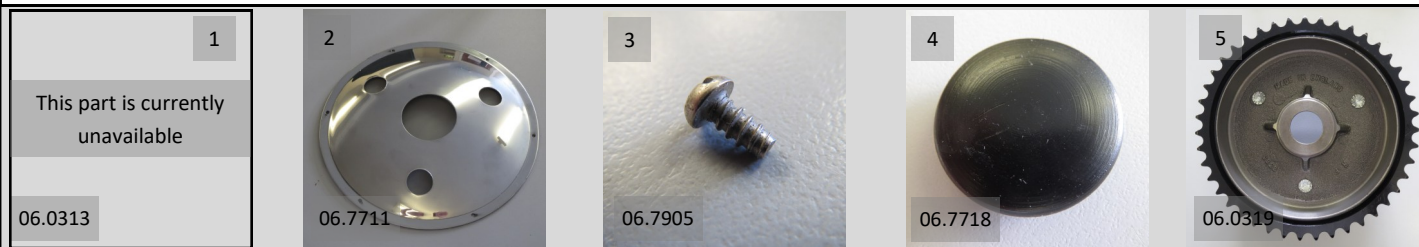



We are the only supplier of Commando & Dominator parts using the original factory drawings. Our products are mostly made in England and to original specification. We also offer Norton Rotary spares, factory service manuals and literature for **NORTON** and **TRIUMPH** motorcycles.

INSIST ON ANDOVER NORTON PARTS PACKAGED WITH OUR A.N. LOGO

NORTON COMMANDO REAR WHEEL (Non Cush drive type 1968 to 1972)

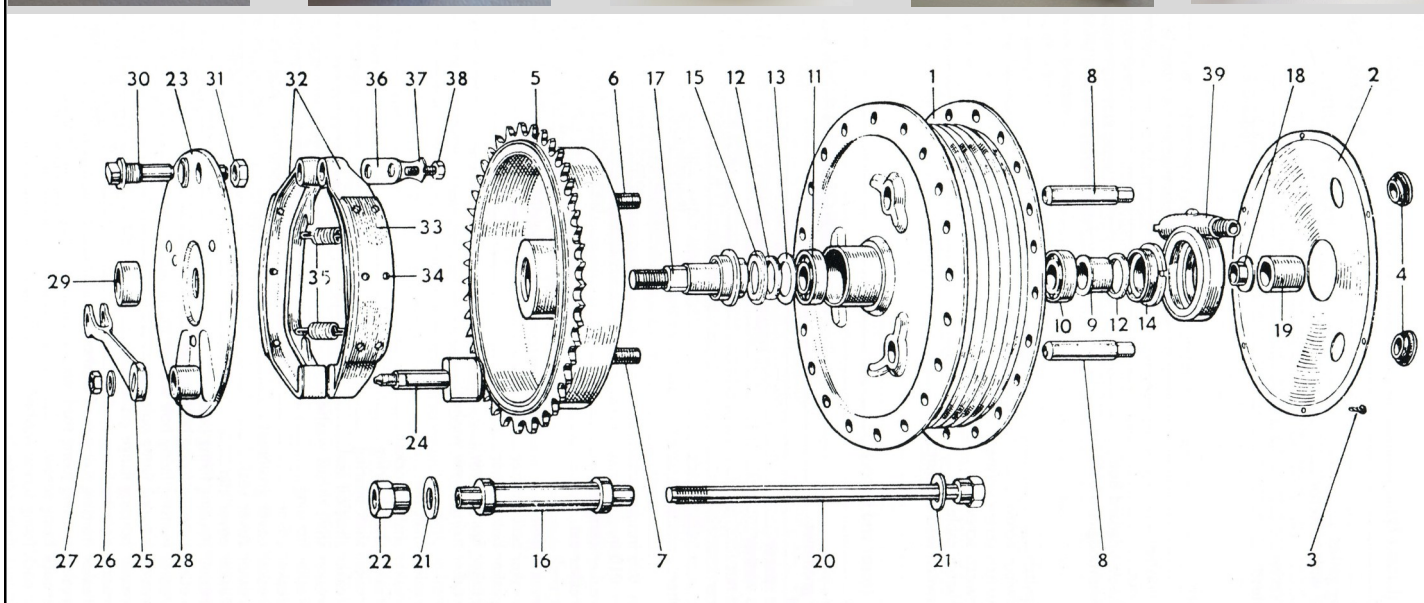

SEE WEBSITE FOR PRICES

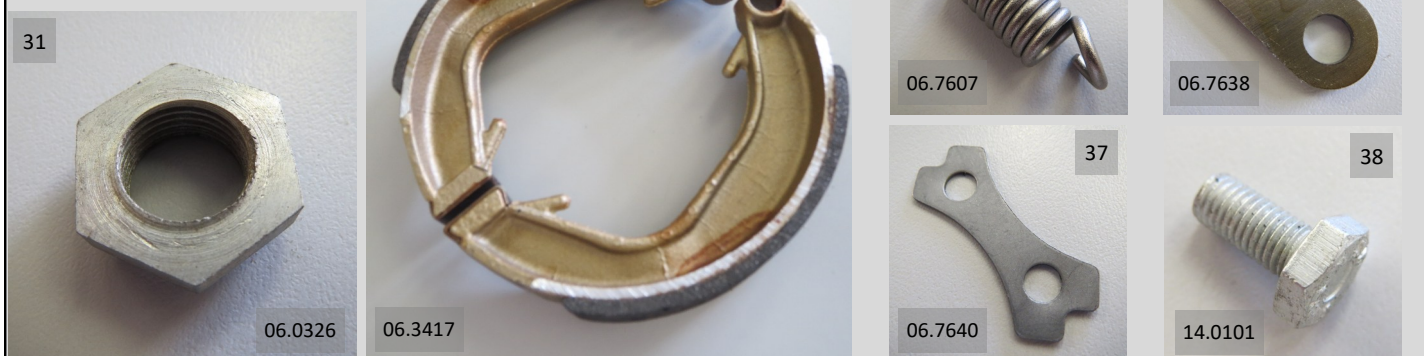



We are the only supplier of Commando & Dominator parts using the original factory drawings. Our products are mostly made in England and to original specification. We also offer Norton Rotary spares, factory service manuals and literature for **NORTON** and **TRIUMPH** motorcycles.

INSIST ON ANDOVER NORTON PARTS PACKAGED WITH OUR A.N. LOGO

NORTON COMMANDO REAR WHEEL (Cush drive type 1972 to 1974)

2 06.0289

3 06.0292

4 06.0324

5 06.0627

6 60.2322

7 14.0303

8 06.0314

9 06.0325

10 06.0326

11 14.0101

12 06.0329

13 06.0332 1972 & 1973 only

13 06.5826 1974 only

14 06.0334

15 06.0701

16 06.0704

17 06.3417

17A 06.0013

18 06.7638

19 06.7640

20 06.7755

21 06.7603

22 06.7607

23 06.5290



We are the only supplier of Commando & Dominator parts using the original factory drawings. Our products are mostly made in England and to original specification. We also offer Norton Rotary spares, factory service manuals and literature for **NORTON** and **TRIUMPH** motorcycles.

INSIST ON ANDOVER NORTON PARTS PACKAGED WITH OUR A.N. LOGO

NORTON COMMANDO REAR WHEEL (Cush drive type 1972 to 1974)













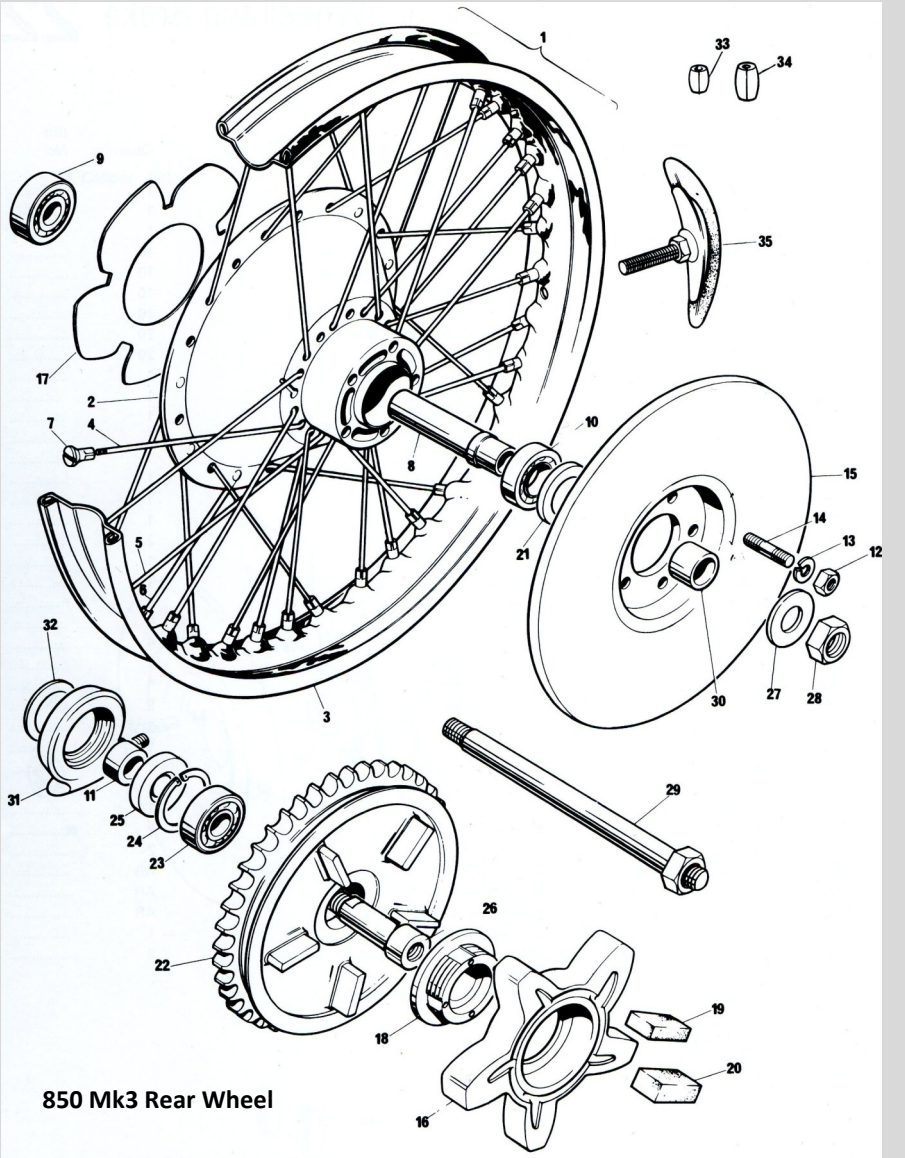

<p>24</p> <p>06.2074</p>	<p>25</p> <p>06.2075</p>	<p>26</p> <p>04.0100</p>	<p>27</p> <p>06.0317</p>	<p>28</p> <p>06.2063</p> <p>This part is currently unavailable</p>	<p>35</p> <p>06.7738</p>
<p>29</p> <p>06.2069</p>					<p>36</p> <p>06.7905</p>
<p>30</p> <p>06.2071</p>	<p>31</p> <p>06.7704</p>	<p>32</p> <p>06.3012</p>	<p>33</p> <p>06.7614</p>	<p>34</p> <p>06.7629</p>	<p>37</p> <p>01.7060</p>
<p>38</p> <p>06.7712</p>	<p>39</p> <p>06.7688</p>	<p>40</p> <p>06.2526</p>	<p>40A</p> <p>06.2525</p>	<p>41</p> <p>02.1693</p>	<p>42</p> <p>06.2082</p>
<p>43</p> <p>06.2764</p>	<p>44</p> <p>06.2067</p>	<p>45</p> <p>06.2072</p>	<p>46</p> <p>06.2889</p>	<p>47</p> <p>06.2090</p>	<p>48</p> <p>06.7688</p>
<p>49</p> <p>02.1693</p>	<p>50</p> <p>02.1693</p>				

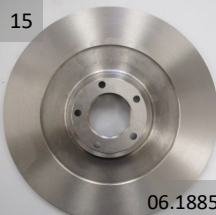

We are the only supplier of Commando & Dominator parts using the original factory drawings. Our products are mostly made in England and to original specification. We also offer Norton Rotary spares, factory service manuals and literature for **NORTON** and **TRIUMPH** motorcycles.

INSIST ON ANDOVER NORTON PARTS PACKAGED WITH OUR A.N. LOGO

NORTON COMMANDO REAR WHEEL 850 MK3 (1975 to 1978)

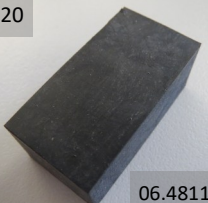
<p>1</p> <p>Not Available</p> <p>06.6128</p>	<p>2</p> <p>Not Available</p> <p>06.6127</p>	<p>3</p> <p>Photo to follow</p> <p>06.6119</p>	<p>4</p>  <p>06.6117</p>	<p>5</p>  <p>06.6116</p>			
<p>6</p>  <p>06.6115</p>	 <p>850 Mk3 Rear Wheel</p>			<p>12</p>  <p>14.0302</p>			
<p>7</p>  <p>06.3207</p>				<p>13</p>  <p>60.2418</p>			
<p>8</p>  <p>06.5550</p>				<p>14</p>  <p>06.1960</p>			
<p>9</p>  <p>06.5541</p>				<p>15</p>  <p>06.1885</p>			
<p>10</p>  <p>06.5542</p>				<p>16</p>  <p>06.6232</p>			
<p>11</p>  <p>06.5547</p>				<p>17</p>  <p>06.4810</p>	<p>18</p>  <p>06.5548</p>	<p>19</p>  <p>06.4812</p>	<p>20</p>  <p>06.4811</p>



We are the only supplier of Commando & Dominator parts using the original factory drawings. Our products are mostly made in England and to original specification. We also offer Norton Rotary spares, factory service manuals and literature for **NORTON** and **TRIUMPH** motorcycles.

INSIST ON ANDOVER NORTON PARTS PACKAGED WITH OUR A.N. LOGO

NORTON COMMANDO REAR WHEEL 850 MK3 (1975 to 1978)

